

## Elbow 90° PE100 SDR17/17,6

- Long spigot version
- 5 bar Gas / 10 bar Water

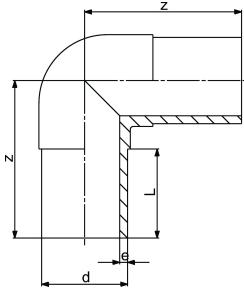

d (mm)	Code	SP	Weight (kg)	PF	z (mm)	L (mm)	e (mm)	PSI
90	<b>753 100 813</b>	1	0.543	2 51 301 001	150	81	5.4	130
110	<b>753 100 814</b>	1	0.876	2 51 301 001	165	86	6.6	130
125	<b>753 100 815</b>	1	0.927	2 51 301 001	180	93	7.4	130
140	<b>753 100 816</b>	1	1.547	2 51 301 001	194	92	8.3	130
160	<b>753 100 817</b>	1	2.385	2 51 301 001	210	102	9.5	130
180	<b>753 100 818</b>	1	3.205	2 51 301 001	232	107	10.7	130
200	<b>753 100 819</b>	1	4.298	2 51 301 001	253	115	11.9	130
225	<b>753 100 820</b>	1	5.864	2 51 301 001	270	120	13.4	130
250	<b>753 100 821</b>	1	8.000	2 51 301 002	292	130	14.8	130
280	<b>753 100 822</b>	1	11.328	2 51 301 002	320	140	16.6	
315	<b>753 100 823</b>	1	15.877	2 51 301 002	370	150	18.7	

The technical data are not binding. They neither constitute expressly warranted characteristics nor guaranteed properties nor a guaranteed durability. They are subject to modification. Our General Terms of Sale apply.

Georg Fischer Piping Systems Ltd, Postfach, CH-8201 Schaffhausen/Switzerland

Phone +41 -(0)52-631 1111

e-mail: [info.ps@georgfischer.com](mailto:info.ps@georgfischer.com)

Internet: <http://www.gfps.com>